

# SS/SSC 1031 Multipole Plugs

All dimensions see note 1)

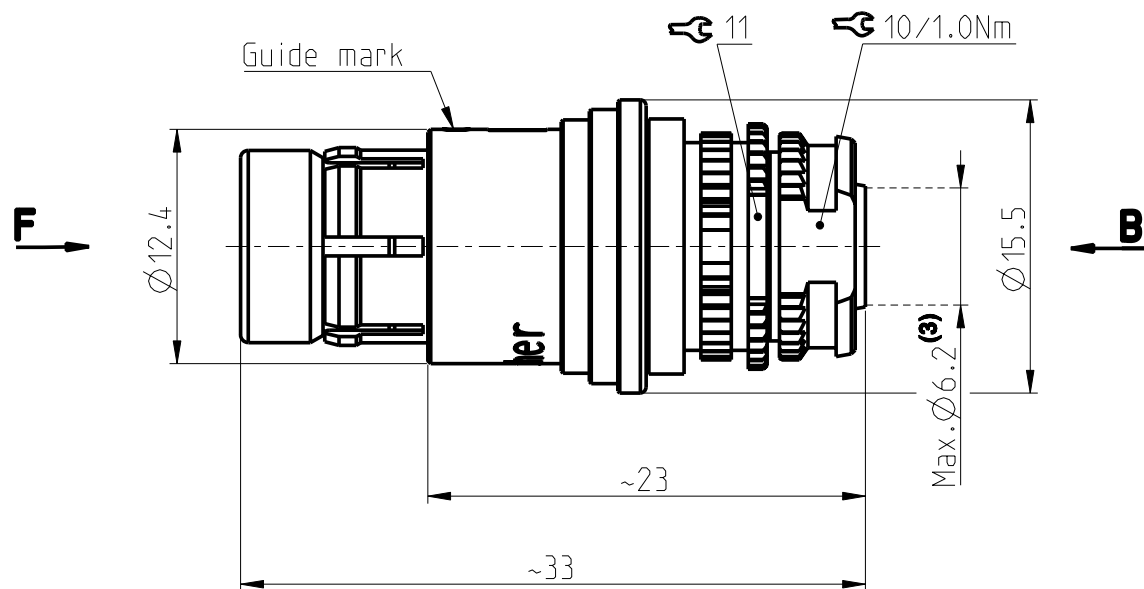

Contact polarity A

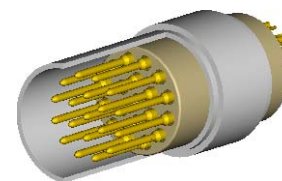

Contact polarity Z

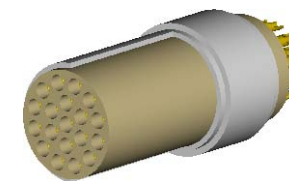

CONTACT CONFIGURATION	Contacts	Solder cup $\varnothing$	Crimp cup $\varnothing$ <sup>(2)</sup>
1031 A Z 010	10	0.79	0.60
1031 A Z 012	12	0.79	0.60
1031 A Z 019	19	0.43	0.43

Contact configuration for polarity A (View from B)

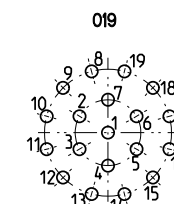
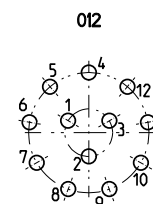
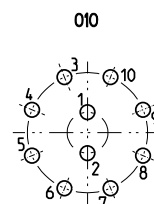

Keying codes (View from F)

Code 1 (-1xx)

Code 2 (-2xx)

Code 3 (-3xx)

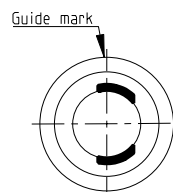
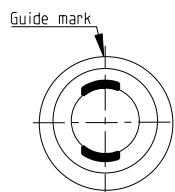
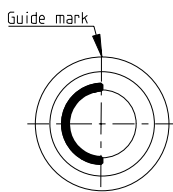

Contact configuration for polarity Z (View from B)

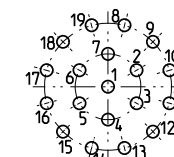
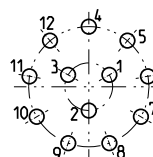
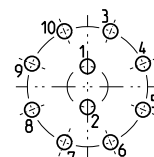

All dimensions in mm

Rev. 1c

Pages 1/1

Notes:

1) All tolerances resulting from connector assembly are typically  $\pm 0.3$ mm

2) For optimum crimping refer to available crimping manual.

3) Max cable diameter below shield.

Part number example : SS 1031 A019-130

600487



www.fischerconnectors.com

Information provided herein is believed to be accurate at time of publishing. Fischer Connectors reserves the right to make modifications on products for continuous improvement without prior notice.