

# DBP 1031 Multipole Receptacles

Contact polarity A

Contact polarity Z

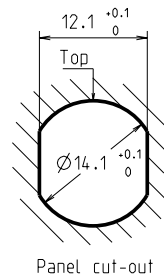
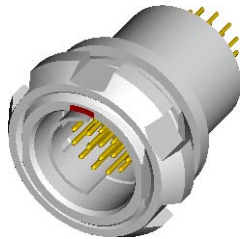
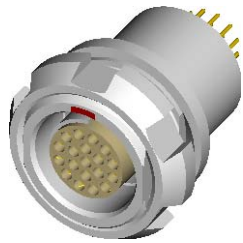

All dimensions see note 1)

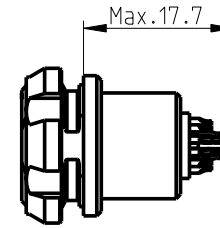

Solder (-x39/-x49)

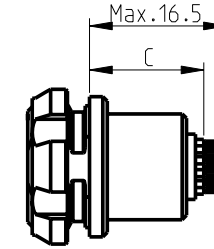

PCB (-x30/-x40)

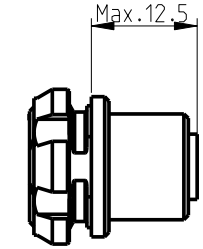

Crimp (-x50/-x60)<sup>(3)</sup>

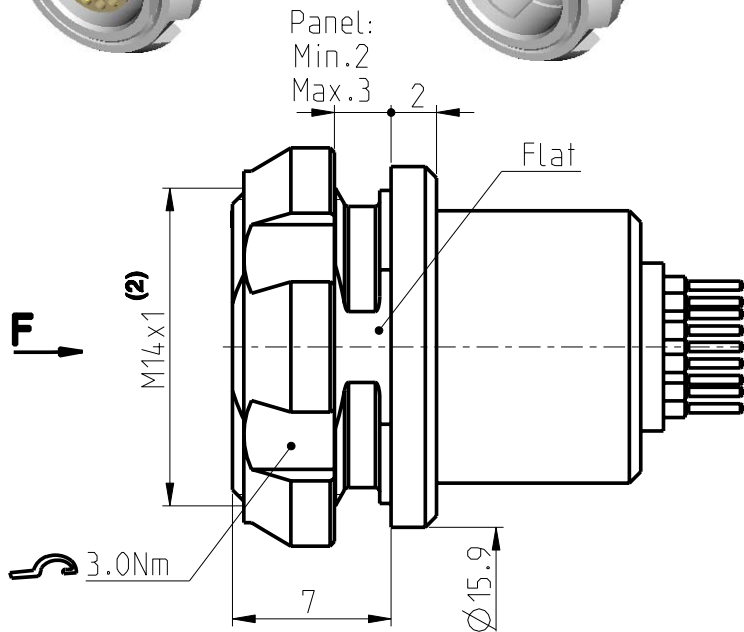

Keying codes (View from F)

Code 1 (-1xx)

Code 2 (-2xx)

Code 3 (-3xx)

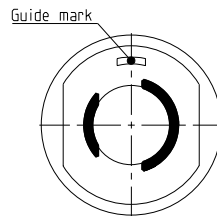
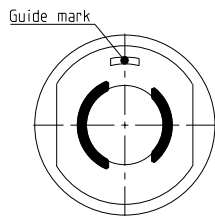
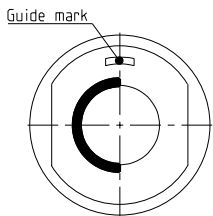

CONTACT CONFIGURATION	Contacts	Solder cup $\phi$	C	PIN $\phi$	Crimp cup $\phi$
1031 A Z 010	10	0.79	13.2	0.50	0.60
1031 A Z 012	12	0.79	13.2	0.50	0.60
1031 A Z 019	19	0.43	13.2	0.40	0.43

Pin layout / PCB hole pattern for polarity A - View from F <sup>(4)</sup>

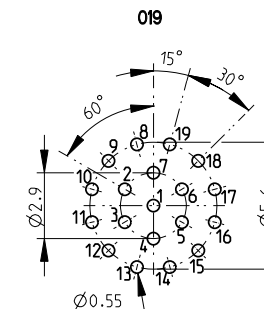
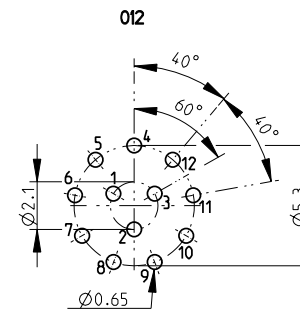
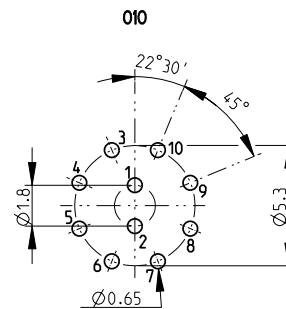

Polarity Z - View from F

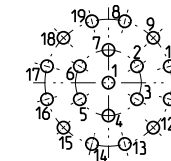
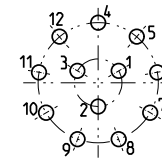
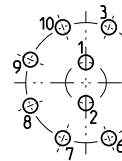

All dimensions in mm

600481

Rev. 2a

Pages 1/1

Notes:

- 1) All tolerances resulting from connector assembly are typically  $\pm 0.3$ mm
- 2) If receptacle is screwed directly into threaded hole, oversize thread by  $+0.05$ mm
- 3) For optimum crimping refer to available crimping manual.

4) Recommended PCB hole dimensions may be adjusted to application  
Part number example : DBP 1031 A019-130

**fischer**  
CONNECTORS

www.fischerconnectors.com