

DBPE/U 1031 Multipole Receptacles

Contact polarity A

Contact polarity Z

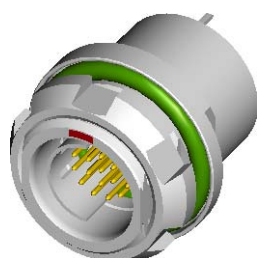
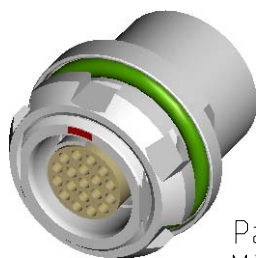

Panel:
Min.1
Max.3

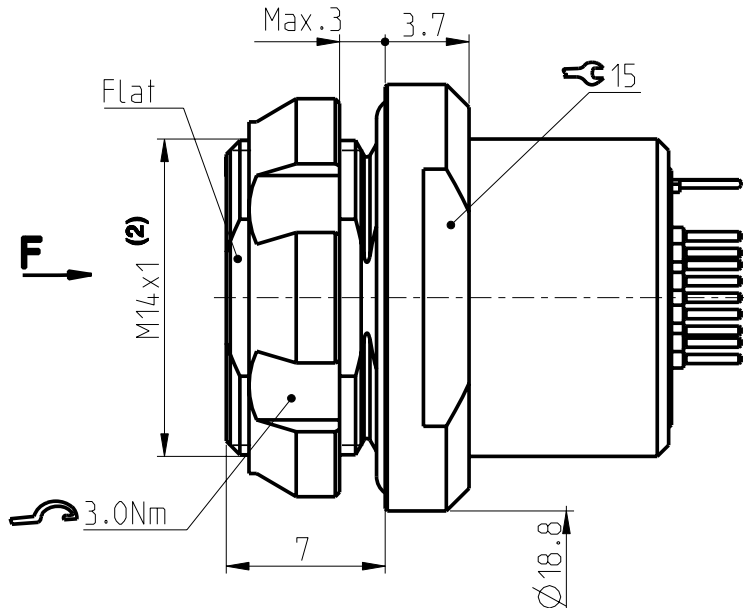
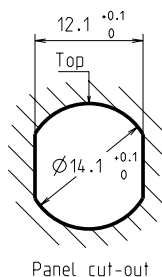

Keying codes (View from F)

Code 1
(-1xx)

Code 2
(-2xx)

Code 3
(-3xx)

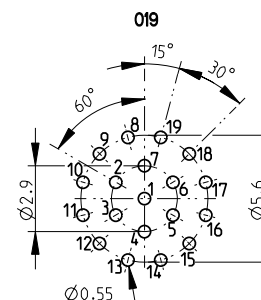
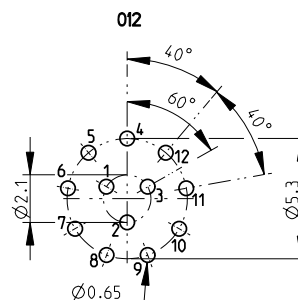
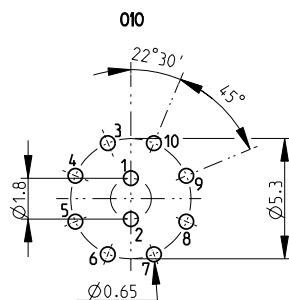
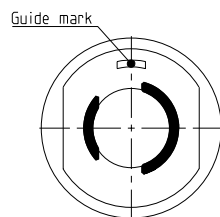
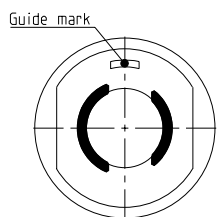
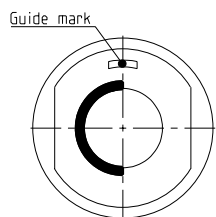

Polarity Z - View from F

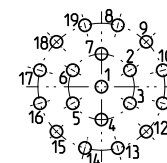
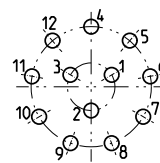
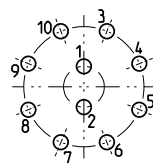

Solder (-x39/-x49)

PCB (-x30/-x40)

CONTACT CONFIGURATION	Contacts	Solder cup ϕ	C	PIN ϕ
1031 A Z 010	10	0.79	13.2 14.0	0.50
1031 A Z 012	12	0.79	13.2 14.0	0.50
1031 A Z 019	19	0.43	13.2 13.0	0.40

All dimensions see note 1)

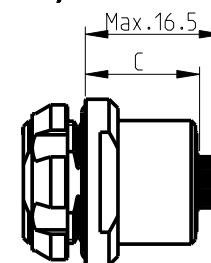
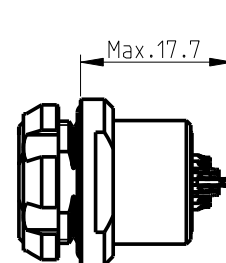

All dimensions in mm

600484

Rev.

2a

Pages

1/1

Notes :

- 1) All tolerances resulting from connector assembly are typically ± 0.3 mm
- 2) If receptacle is screwed directly into threaded hole, oversize thread by $+0.05$ mm

3) Recommended PCB hole dimensions may be adjusted to application
Part number example : DBPE 1031 A019-130

fischer
CONNECTORS

www.fischerconnectors.com