

DBPLE/U 103 Multipole Receptacles

Contact polarity A

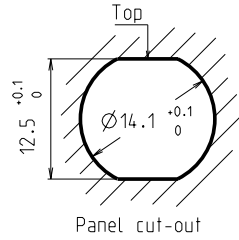

Contact polarity Z



All dimensions see note 1)

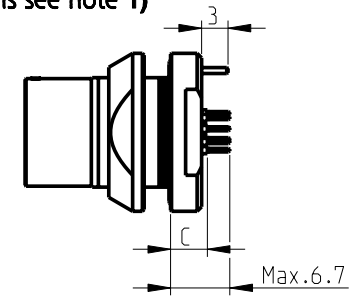
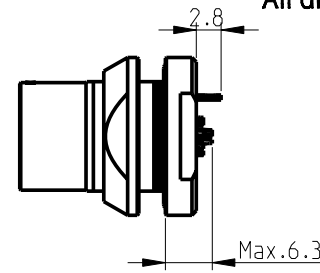

Solder (-x39/-x49)

PCB (-x30/-x40)

CONTACT CONFIGURATION	Contacts	Solder cup \varnothing	C	PIN \varnothing
103 A Z 051	2	1.18	4.2	0.7
103 A Z 052	3	1.18	4.2	0.7
103 A Z 053	4	0.79	4.2	0.7
103 A Z 054	5	0.79	4.2	0.7

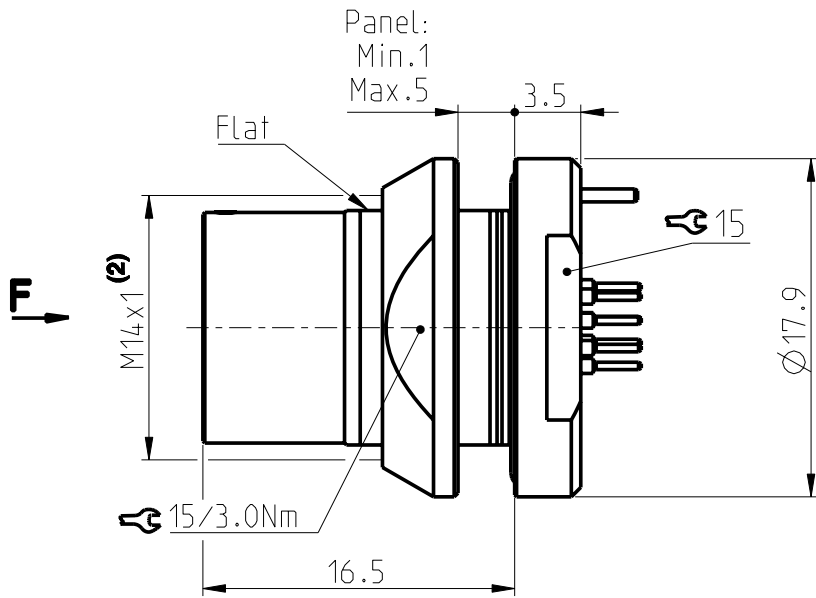

Pin layout / PCB hole pattern for polarity A - View from F (3)

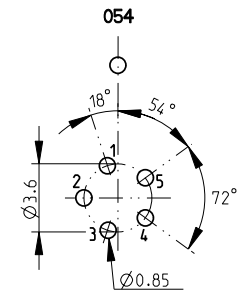
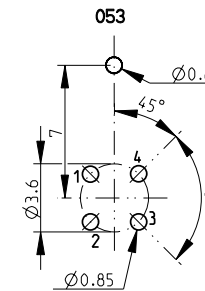
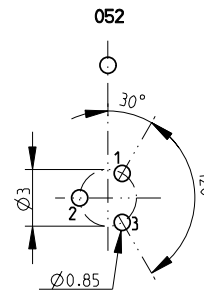
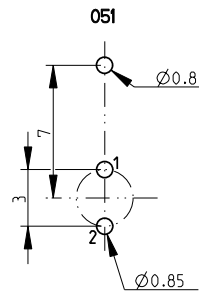

Polarity Z - View from F

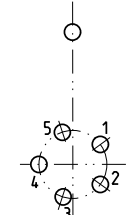
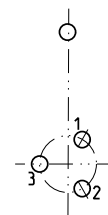
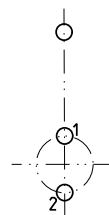

Keying codes (View from F)

Code 1 (-1xx)

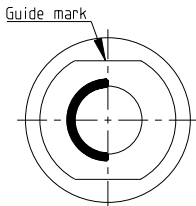

Code 2 (-2xx)

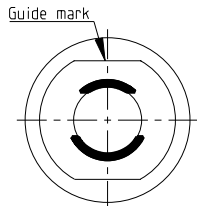

Code 3 (-3xx)

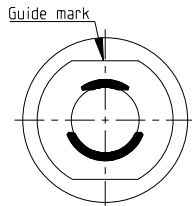

All dimensions in mm

600491

Rev.

2a

Pages

1/2

Notes:

- 1) All tolerances resulting from connector assembly are typically $\pm 0.3\text{mm}$
- 2) If receptacle is screwed directly into threaded hole, oversize thread by $+0.05\text{mm}$

3) Recommended PCB hole dimensions may be adjusted to application
Part number example : DBPLE 103 A062-130

fischer
CONNECTORS

www.fischerconnectors.com

DBPLE/U 103 Multipole Receptacles

Contact polarity A

Contact polarity Z

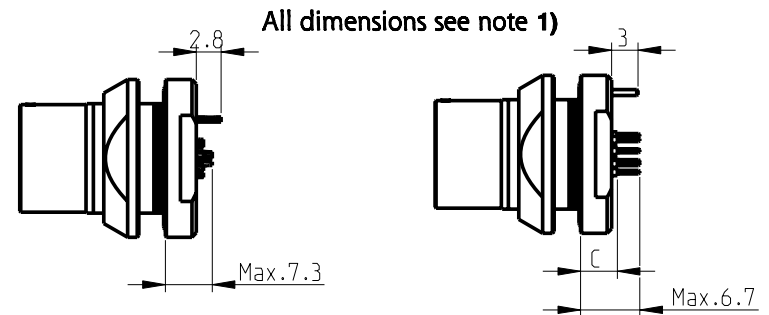
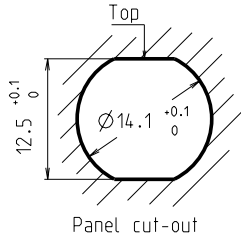
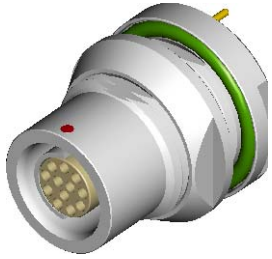

Solder (-x39/-x49)

PCB (-x30/-x40)

CONTACT CONFIGURATION	Contacts	Solder cup \varnothing	C	PIN \varnothing
103 A Z 056	6	0.79	4.2	0.50
103 A Z 057	7	0.79	4.2	0.50
103 A Z 058	8	0.79	4.2	0.50
103 A Z 062	12	0.43	4.2	0.40

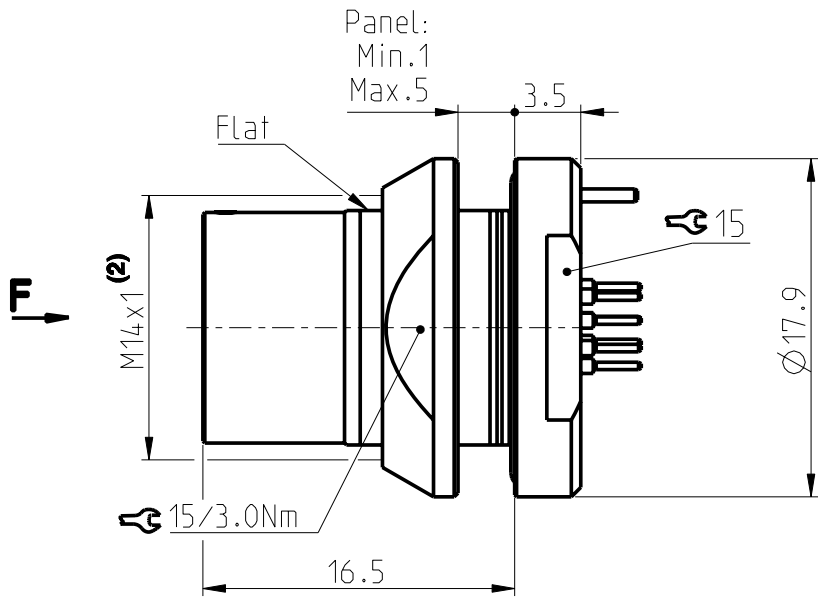

Pin layout / PCB hole pattern for polarity A - View from F (3)

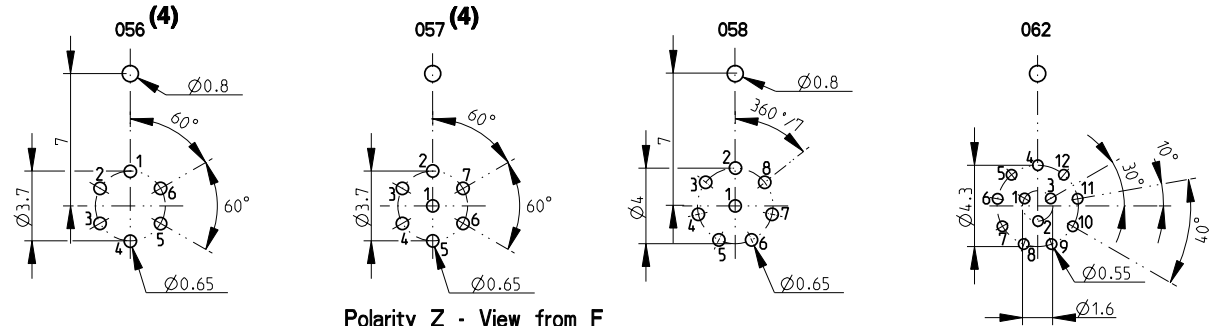

Polarity Z - View from F

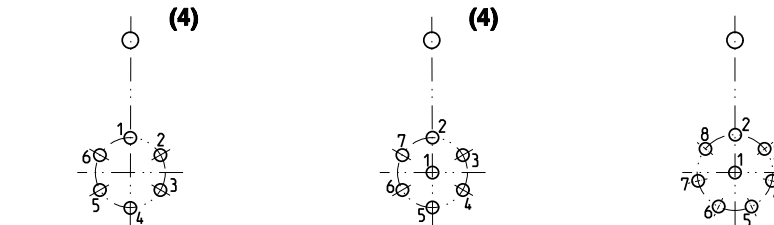

Keying codes (View from F)

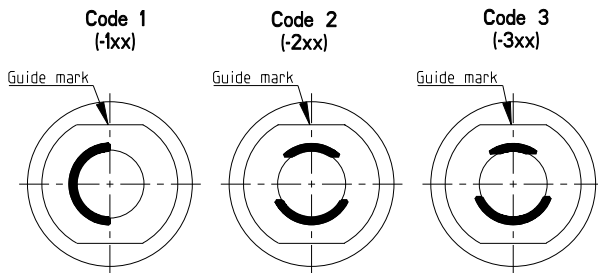

All dimensions in mm

600491

Rev.

2a

Pages

2/2

Notes:

- 1) All tolerances resulting from connector assembly are typically $\pm 0.3\text{mm}$
- 2) If receptacle is screwed directly into threaded hole, oversize thread by $+0.05\text{mm}$

3) Recommended PCB hole dimensions may be adjusted to application

4) Only valid for Code 1. For other codes please contact us.

Part number example : DBPLE 103 A062-130

fischer
CONNECTORS

www.fischerconnectors.com